

# FS400-1200

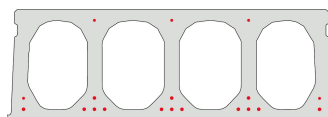

## Technische info

|                  |                                      |
|------------------|--------------------------------------|
| Hoogte           | 400mm                                |
| Breedte          | 1200mm                               |
| Brandweerstand   | 1 uur (2u op bestelling)             |
| Milieuklasse     | XC1; XC2; XC3 (andere op bestelling) |
| Transportgewicht | 4,32 kN/m <sup>2</sup>               |
| Gewicht/ m       | 5,18 kN/m                            |
| Rekengewicht     | 4,68 kN/m <sup>2</sup>               |
| Kanaalvulling    | 64,23 l/m                            |
| Vulbeton         | 13,6 l/m <sup>2</sup>                |
| Betonkwaliteit   | C 50/60                              |
| Staalkwaliteit   | f(pk) 1860; f(p0,1k) 1580            |

## Overspanningen

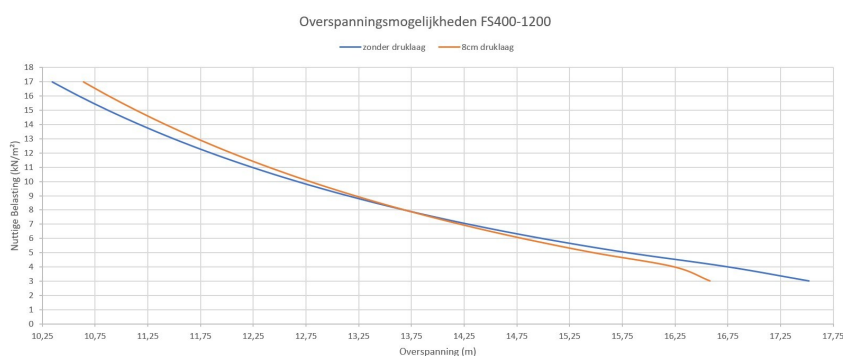

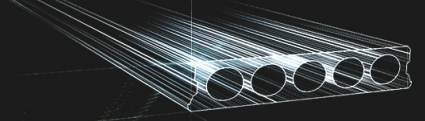

## Pasplaten

---

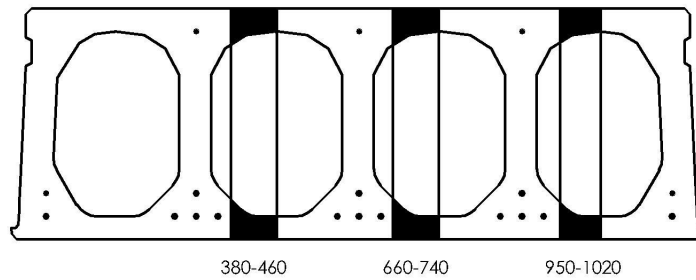

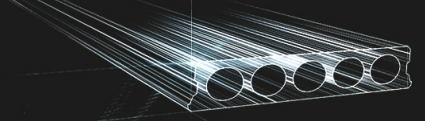

## Booradvies

---

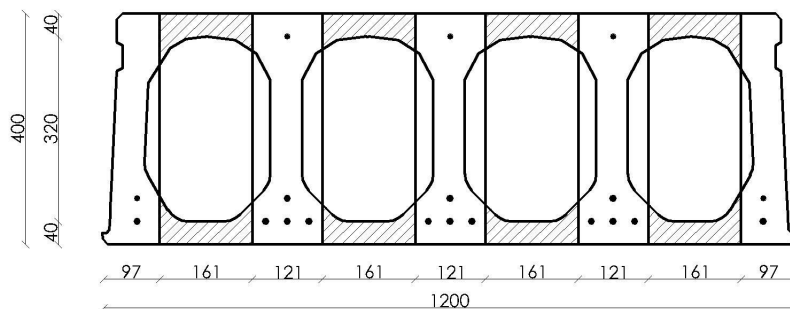

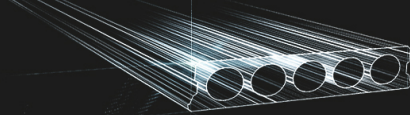

## Wapeningspositie

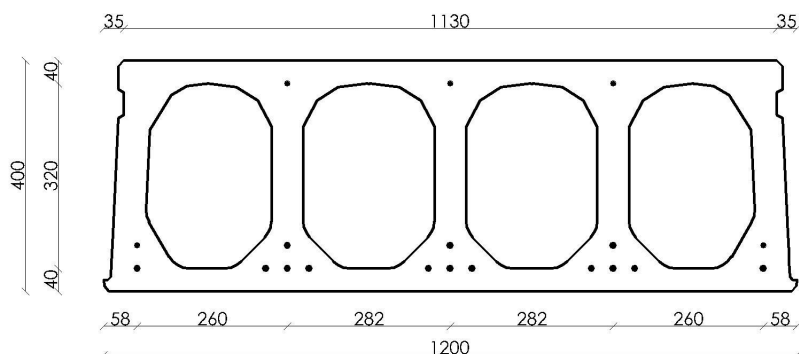

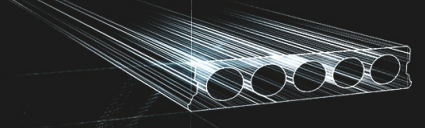

## Supplementen

---

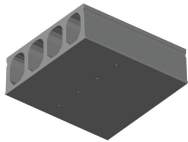

Ontwateringsgaatjes

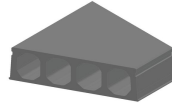

Schuinzagen/inkorten

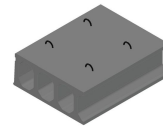

Hijsslussen

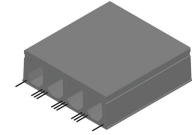

Uitstekende wapening

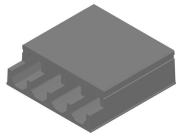

Verdunde bovenzijde



Hoeksparing

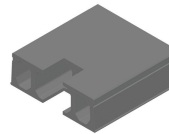

Kopsparing

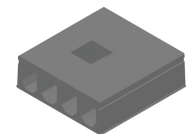

Middensparing

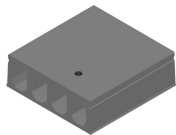

Ronde sparing + CD

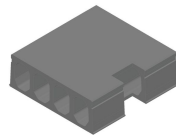

Zijsparing

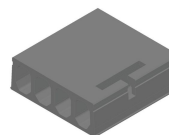

Hamerkop

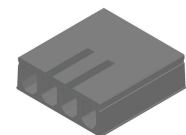

Opengemaakte kanalen

Raveelijzers -  
Voorgespannen

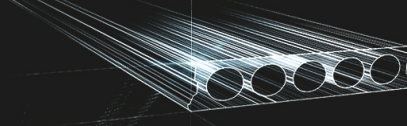

## Voorraad

|             | Productie | Afhaalbaar | Op voorraad |
|-------------|-----------|------------|-------------|
| Malle 1     |           |            |             |
| Malle 2     | X         | X          |             |
| Frederickx  |           |            |             |
| Tessenderlo | X         | X          |             |

Gedownload op: 08/06/2020 06:11:23



**Fingo**  
 Malle 1 Nijverheidsstraat 21  
 Malle 2 Industrieweg 22  
 Malle B-2390  
 +32 (0)3 309 26 26

**Fingo Tessenderlo**  
 Truibroek 76  
 Ham B-3945

fingo@fingo.be

**Fingo - Frederickx**  
 Schuttersveldstraat 11  
 Messelbroek B-3270  
 +32 (0)13 78 00 78

pagina 6 / 6